

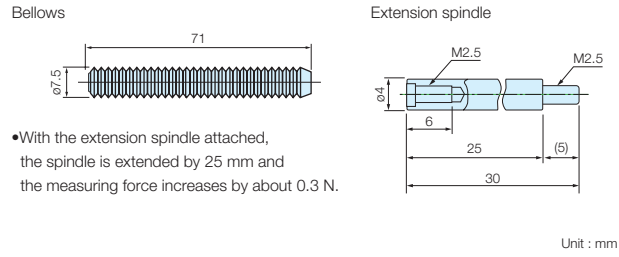

# Accessories

## DZ301 Bellows set (for DL330B, DE30BR)



## DZ302 Bellows set (for DE12BR)

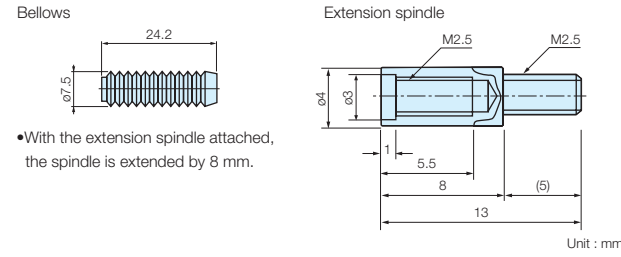

## DZ-100 Roller feeler (for DT Series, DG-B Series: except for DG155BP/205BP)

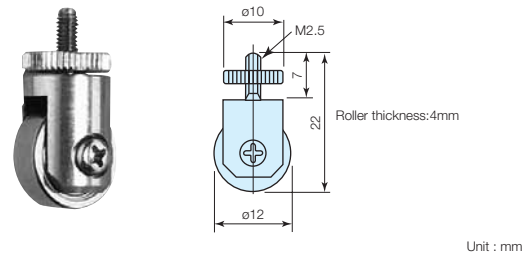

## DZ-121 Feeler (for DG100BP/BN)

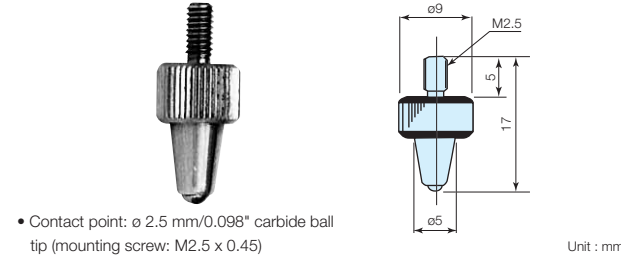

## DZ-122 Feeler (for DG10B to DG50B)

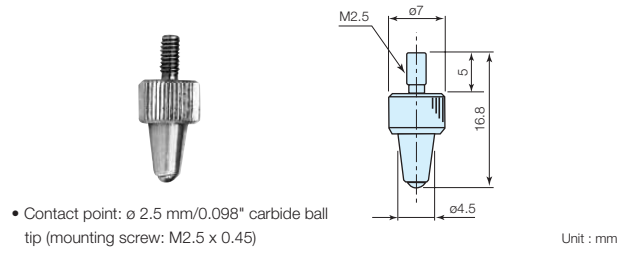

## DZ-123 Feeler (for DG805BL/810B/810BL)

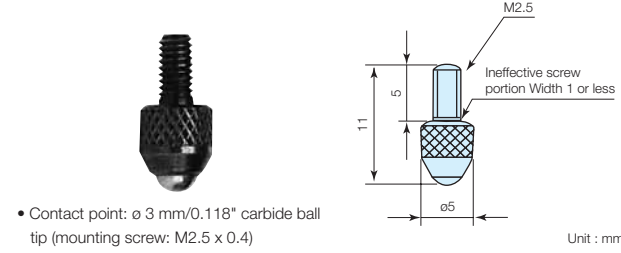

## DZ-181 Magnetic contact point feeler (for DG155BP/205BP)

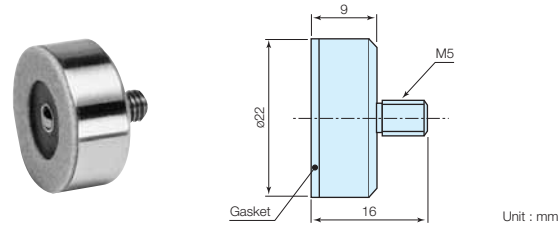

## DZ-191 Coupling

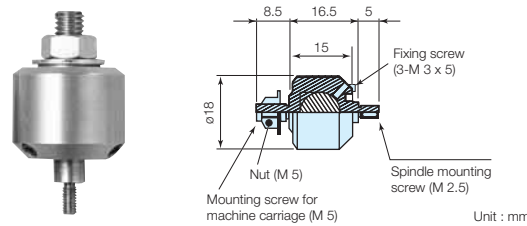

## DZ-5100 Feeler set

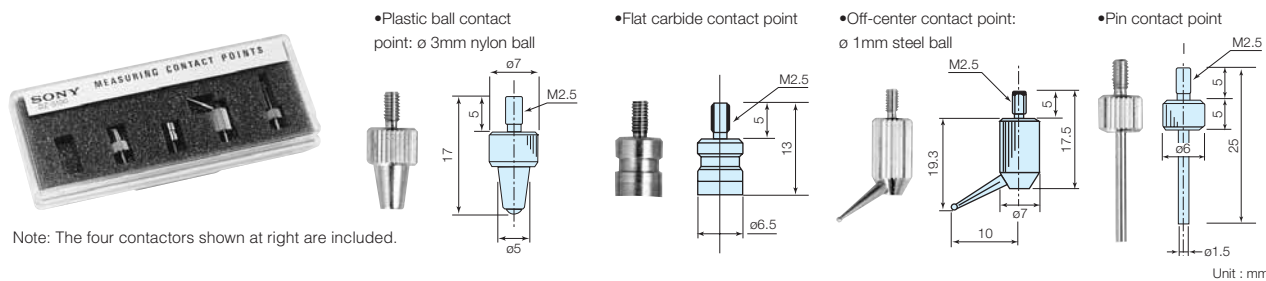

## Other accessories

- Cable connectors for computer connection (for U Series/ LT Series/ LY Series) DZ252 (round 8 pin ↔ D sub 9 pin) (2 m) DZ253A (round 8 pin ↔ D sub 25 pin) (2 m)
- \* For U Series, use Sony's battery and charger (for details, consult your local distributor).
- DZ254 (round 8 pin ↔ unterminated end)
- Extension cable (for DT512N/P, DT12N/P) : CE08-1(1m), CE08-3(3m), CE08-5(5m), CE08-10(10m), CE08-15(15m)
- LZ52 Multistage connecting cable: Connects LY51 units or LY52 units via RS-232C.

## SZ70-1 Adapter

- SZ70-1 is required for connecting the following scale units and counters:  
 Scale unit: GB-A, SR801, MSS-101 and SR118  
 Counter: LH71A, LH72-3, LY71 and LY72  
 \* Adapter SZ51-MS01 is also required except GB-A.

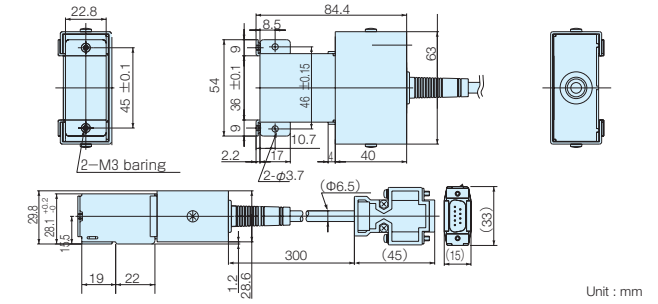

# Connection Cables

Measuring unit	Adpter for LT series	LT series	Interface unit	Adapter for Counter	Connection cable	Counter	Interpolators	Expnsion cables
DK802A/812A/805A	-	LT30	MG (MG10-P1/P2) (MG20-DK) (MG30-B1/B2)	-	CE-29-**	LH70/71 LY71,LY72	-	CK-T**
DK-10/25								
DK-50/100								
DK-155PR5/205PR5								
DK-110NLR5								
DT12N/P	-	LT10A	MG (MG10-P1/P2) (MG20-DT) (MG30-B1/B2)	-	-	-	MT11	-
DT32N/NV/P/PV				-				
DT512N/P		LT11A	-	-	-	-	-	-
DG-805B/810B	DZ51 + SZ70-2	LT30	MG (MG10-P1/P2) (MG20-DG) (MG30-B1/B2)	DZ51 + SZ70-1	-	LH70/71/72-3 LY71,LY72	MD10A/20B ※D-sub15pin (Male・EFemale)	-
DG-10B/25B								
DG-50B/100B/155B/205B								
DG-110B								
DG-805B/810B	-	LT20A	MG (MG10-P1/P2) (MG20-DG) (MG30-B1/B2)	-	-	LH70/71/72-3 LY71,LY72	-	-
DG-10B/25B								
DG-50B/100B/155B/205B								
DG-110B								
DL-B DL-BR	DZ51 + SZ70-2	LT30	MG (MG10-P1/P2) (MG20-DG) (MG30-B1/B2)	DZ51 + SZ70-1	-	LH70/71/72-3 LY71,LY72	-	-
	-	LT20A						
DE-BR	SZ70-2	LT30	MG (MG10-P1/P2) (MG20-DG) (MG30-B1/B2)	SZ70-1	-	LH70/71/72-3 LY71,LY72	-	-

# Compatible

Measuring unit	Adpter for LT series	LT series	Adapter for Counter	Connection cable	Counter	Interpolators	Expnsion cables
DK-10/25	-	-	D-sub 9pin (Female) + SZ51-AB01 *High density D-sub is required to connect to LY20.	-	LH51/52/61 LY51,LY52	-	CK-T**
DK-50/100							
DK-155PR5/205PR5							
DK-110NLR5							
DT12N/P	MT12 LZ60-P1/P2 is required to connect to LT100.	LT20 LT100	MT12 + DZ51	-	LH51/52/61 LY51,LY52	-	-
DT32N/NV/P/PV							
DT512N/P							
DT12N/P	-	LT10	-	-	-	-	-
DT32N/NV/P/PV	-	LT11	-	-	-	-	-
DT512N/P	-	LT10	HA13 (Only repair service)	-	LU10A LH20	-	-
DG-805B/810B	-	LT20 LT100	HA13 (Only repair service)	-	LU10A LH20	-	-
DG-10B/25B							
DG-50B/100B/155B/205B							
DG-110B							
DG-805B/810B	-	LT20 LT100	HA31 (Only repair service)	-	LH31/32/41/42	-	-
DG-10B/25B							
DG-50B/100B/155B/205B							
DG-110B	-	LT20 LT100	DZ51	-	LH51/52/61 LY51,LY52	-	-